

# Alaska Anthropological Association Newsletter



Volume 37, Number 4

February 2012

## In This Issue

President's Message.....	2
Call for AJA Editor.....	3
40 <sup>th</sup> Annual AAA Meetings.....	4
Donations.....	4
Out and About – Recent Happenings.....	5
Recent Publications.....	6
In Memory.....	8
Membership and Journal Subscription....	12
Other Meeting of Interest.....	14
Advertisement.....	14
39 <sup>TH</sup> Annual AAA Meetings Preliminary Program.....	15
Hotel and Directions.....	16
Preliminary Program.....	19

## 39th Annual Meeting Alaska Anthropological Association

**February 29 – March 3, 2012**

Hotel Deca, University District  
Seattle, WA

Sponsored by the University of Washington  
Department of Anthropology and the Burke  
Museum of Natural and Cultural History with  
the Burke Archaeology Department

### Quick Facts:

Deadlines for early registration have passed.  
Registration is available online.  
Hotel Rooms at Hotel Deca, as soon as possible. Limited rooms available.  
Donated space for free student lodging, very limited. See below for contact information.  
Registration can be made from the "aaa" website's annual meeting page.

### ***Correction to Saturday's Schedule at a***

***Glance:*** The Belzoni 'meeting' starts at 7 p.m., not 8 p.m. it was incorrectly scheduled in the first version on the web site.

For information and registration for the 2012 meetings  
of the Alaska Anthropological Association, go to:

<http://www.alaskaanthropology.org/index.cfm?section=annual-meeting&page=Annual-Meeting>

## A Message from the President

*Kerry D. Feldman, Association President*

The Alaska Anthropological Association mourns the deaths of two of its long-standing members, supporters and contributors: Tom Eidel and Dr. Deanna Kingston. Their obituaries are included in this *Newsletter*. Tom was one of the first undergraduate majors in anthropology whom I met when I came to the University of Alaska Anchorage in 1973. There were only 20 anthropology majors in Anchorage at the time, being taught by faculty at the then Anchorage Community College: Linda Ellanna, Robert Mack, and Leslie Richards, with Nancy Y. Davis and me at the Senior College of UAA. Tom's devotion to northern anthropology was palpable even as an undergraduate, as well as his keen sense of humor. Deanna earned her doctorate in anthropology at the University of Alaska Fairbanks in 1999. Her NSF funded (2003) King Island traditional ecological research was just one highlight of her inspiring career. On behalf of our association, I extend my heartfelt condolences to their loved ones, families and friends. We treasure their memories even as we share the grief at their passing.

We recently lost two other esteemed northern anthropologists. Their obituaries also will be published in this *Newsletter*: Doug Gibson of Eagle River, Alaska, an archaeologist employed during his career by the State of Alaska, the National Park Service, and BLM, and Dr. Ruslan Sergeyevich Vasilevskiy of the Institute of Archaeology and Ethnography (Siberian Division, Russian Academy of Science).

In this *Newsletter* you will find a call for applications for editor of the *Alaska Journal of Anthropology* beginning January 2013 [selection of the new editor will be made June, 2012 to allow for overlap with the current editor]. Current editor, Owen Mason, notified our Board of Directors this past fall that he thought it was time to turn the editorship over to someone else after ten years as editor. Owen has been the only editor our fledgling journal has known, bringing it from an idea to very successful fruition. I can't thank him

## ALASKA ANTHROPOLOGICAL ASSOCIATION

### President

Kerry Feldman

### Board Members

Joan Dale

Karlene Leeper

Jenya Anichenko

Monty Rogers

Robin Mills

### Secretary

Karlene Leeper

### Treasurer

Rita Eagle

*The purpose of the Alaska Anthropological Association is to serve as a vehicle for maintaining communication among people interested in all branches of anthropology; to promote public awareness and education of anthropological activities and goals; to foster sympathetic appreciation of the past and present cultures of Alaskan peoples; to encourage Alaskan Natives to participate in the elucidation of their respective cultures; and to facilitate the dissemination of anthropological works in both technical and non-technical formats. Membership is open to any individual or organization indicating interest and concern for the discipline of anthropology. The Association holds its annual meeting during March or April of each year and generally publishes four newsletters each year.*

*The membership cycle begins each year on January 1. Annual membership dues include a subscription to the Alaska Journal of Anthropology. Dues are \$40.00 for student members and \$75.00 for regular members. Checks or money orders, in US dollars, should be made out to the Alaska Anthropological Association.*

*To become a member, send a membership form and payment to the Alaska Anthropological Association at P.O. Box 241686, Anchorage, Alaska 99524-1686, USA. Items for the newsletter may be sent to the editor, Pat McClenahan, at the above address, attention "Newsletter Editor," or to [plmcclenahan@gci.net](mailto:plmcclenahan@gci.net).*

enough for his devoted and outstanding service but we will try to do so at our 2013 conference to be held in Anchorage (which will be a fun toast and roast, I suspect).

Our 39<sup>th</sup> Conference, to be held in Seattle from February 29 to March 3, 2012, should be unusually memorable, not only historic. You don't want to miss it. Elsewhere in this *Newsletter* you will find the program and schedule for the conference. I also heard a reliable rumor that this year's Belzoni Society meeting at the conference will have some surprises you won't want to miss. (Diane Hanson, who as a student originated our Belzoni Society [sometime in the late 19<sup>th</sup> century], has found a recent book about the history of Belzoni's contributions to all that we hold dear. More surprises are in store for you). If you haven't made your reservations for the meeting, there is still time to do so. Students are especially urged to be part of this first-ever, Lower 48, Alaska Anthropological Association conference. We can't thank Ben Fitzhugh and his conference planning team at the University of Washington, Department of Anthropology, enough for hosting this conference.

And finally, welcome to the two new members of our Board of Directors: April Laktonen Counciller and Jeff Rasic. And thanks to our two departing Board members: Karlene Leeper and Joan Dale, both of whom are serving two terms of office. Karlene and Joan have done a lot more for our association than serving on the Board. I look forward to our meeting of the Board of Directors at the 39<sup>th</sup> Conference when we welcome April Laktonen Counciller and Jeff Rasic.

See you all in Seattle!

### **Call for applications for Editor of the *Alaska Journal of Anthropology* (AJA)**

*Kerry D. Feldman, Association President*

The Alaska Anthropological Association will accept applications for the position of editor of its journal, the *Alaska Journal of Anthropology* (AJA), beginning March 4, 2012. Applications will be sent via email to Kerry Feldman,

President of the Alaska Anthropological Association at [kdfeld1@gmail.com](mailto:kdfeld1@gmail.com). The selection of the new editor will occur after June 1, 2012 and be announced that month. This will allow an overlap between the incoming editor/editor team and the current editor, Owen Mason, until January 1, 2013. The new editor will be responsible for publication of two volumes each year beginning in 2013. The successful applicant(s) must be members of the Alaska Anthropological Association at the time of application and selection. Co-editors may apply (no more than two co-editors). **See the Association's website soon for application instructions.** Applications received after May 25, 2012 will not be considered. The applications will be reviewed by the association's Board of Directors and President.

### **Qualifications sought for the incoming editor/co-editors of AJA**

*Communication and interpersonal skills essential for this position:*

1. As a representative of the Alaska Anthropological Association, must carry out all duties in a manner that reflects ethical, respectful behavior and consistent professionalism.
2. Strong interpersonal skills:
  - a. Must have the ability to work cooperatively and productively with other AJA staff, the AJA Editorial Board, and Officers of the Association;
  - b. Must be able to work and communicate effectively and respectfully with authors and reviewers;
  - c. Ideally, consummate negotiator;
3. Must be highly organized and detail oriented.

*Editorial and related skills, commitment and experience:*

4. Ideally, experience reviewing and editing scholarly works;
5. Familiarity with and commitment to the peer-review process, preferably with a record of publications in peer-reviewed journals such as *AJA*;
6. Must be committed to producing a high-quality professional journal while also

maintaining the production schedule of one volume (two issues) per calendar year;

7. Willing to engage in marketing of the journal.

*Knowledge base:*

8. Substantial knowledge of Northern cultures, history and anthropology in general.

## **Announcement of the AAA 40<sup>th</sup> Annual Meeting**

*Ken Pratt, Meeting Co-Organizer*

The 40<sup>th</sup> Annual Meeting of the Alaska Anthropological Association will be held in Anchorage in Spring 2013 and co-hosted by the Smithsonian Arctic Studies Center and Bureau of Indian Affairs, ANCSA Office. Additional details will be available soon. It is not too early to think about organizing a symposium for the 2013 meeting. To discuss any such ideas please contact either Aron Crowell (907-929-9207; [CROWELLA@si.edu](mailto:CROWELLA@si.edu)) or Ken Pratt (907-27103695; [Kenneth.Pratt@bia.gov](mailto:Kenneth.Pratt@bia.gov)).

## **Grateful Acknowledgement of Donations**

*Rita Eagle, Association Treasurer*

The Alaska Anthropological Association gratefully acknowledges the following contributions:

### **Student Scholarships**

Robert and Lillian Ackerman  
Kerry Feldman  
Diane Hanson  
Ted Parsons  
Douglas and Kathryn Veltre  
William and Karen Workman

### **Stefanie Ludwig Memorial Scholarship**

Claire Alix and David Koester  
Shina duVall  
Terry Fifield  
John Hoffecker  
Julie Hollowell

Owen Mason  
Allison McLain  
Dave McMahan  
Robyn Miller  
Madonna Moss  
Steven Street  
Douglas and Kathryn Veltre  
Dale Vinson

### **Alaska Consortium of Zooarchaeologists**

Christyann Darwent  
Kelly Eldridge  
Diane Hanson  
Elizabeth G. Wilmerding  
Michael and Linda Finn Yarborough  
David Yesner

### **Publication Fund**

Donald Clark  
Erica Hill  
William and Karen Workman

### **Public Education Group**

William Brown  
Michael and Linda Finn Yarborough

### **Alaska Anthropological Association**

Pete Bowers  
Janell Smith

### **Student Banquets/Luncheons**

Ken Pratt

### **Conference Sponsorship**

Mark Cassell, Territory Heritage Resource Consulting

### **Thomas Eidel Memorial Fund**

Judyann and Harlan Hirt

***Treasurer's Note:*** All of the donations listed above have been received since November! Many thanks to you, our very generous members. We appreciate your support and the confidence you have in our projects and activities.



## Out and About

Pat McClenahan, Newsletter Editor



Georgeie, Big Ray's, Fairbanks, Nov 2011

**Georgeie Reynolds** was in town recently. She is now Senior Tribal Liaison for the US Army Corps of Engineers. She oversees a national program of outstanding professionals who interface with all Federally Recognized Tribes to work on water resources issues. She has spent a lot of time in the Dakotas with many of the Lakota Sioux Nations and in the Southwest with several Pueblos. In addition, she teaches a course called "Consulting with Tribal Nations" twice a year throughout the US. The most recent session was held in Anchorage and sponsored by the Alaska District Corps of Engineers. Her most recent Tribal visits were to Gambell and Savoonga, the week of 12-16 December. Brrrrr. You can take the gal out of Alaska but not the other way around. Catch Georgeie's blog at [www.archaeofun.com](http://www.archaeofun.com) and read stories about the storied recent past of Alaskan archaeology that include a cast of thousands. Also, there are essays on Carhartts, day packs, and hypothermia for your reading pleasure. Georgeie's e-mail address is [archaeofun@aol.com](mailto:archaeofun@aol.com) and she can also be reached at:

Georgeie Reynolds, Ph.D.

Senior Tribal Liaison

Leader, Tribal Nations Community of Practice

US Army Corps of Engineers

202 761-5855 (fon)

202 761-4370 (fax)

For more information on the Corps' Tribal program, go to

<http://usace.army.mil/CECW/Tribalissues/Pages/ArticleTemplate.aspx>

\*\*\*

Did you see the NEWSFOCUS article, **The Peopling of the Aleutians**, in the January 13, 2012 journal **SCIENCE**? The article, written by **Michael Balter**, highlights recent archaeological, ethnographic, and genetic research that addresses issues in the dynamics of island colonization, specifically the populating of the Aleutian Islands at the end of the last major Pleistocene glacial event.

The article showcases the ongoing research of geneticists **Dennis O'Rourke** of the University of Utah, **Michael H. Crawford** of the University of Kansas and **Dixie L. West** of Kansas State University; archaeologists **Debra Corbett** of USFWS Alaska Region, **Diane Hanson** of the University of Alaska Anchorage, **Joan Brenner Coltrain** of the University of Utah Salt Lake City, **Lucy Lewis-Johnson** and **Richard Davis** of Bryn Mawr College, and other important and influential scientists and residents in the region who are participating in the discussion. You can read the full article in **SCIENCE** Vol. 335:158-161 and online at [www.sciencemag.org](http://www.sciencemag.org), where there is a podcast interview with the author.



UAA - USFWS Crew in the Aleutians, Summer 2011.

\*\*\*

**CONGRATULATIONS!** to our Association Treasurer **Rita Eagle** and her new husband, **Dru Malone** who were married on Keonelo Bay, Poipu, Kauai, December 21, 2011. Dru has been a glass artist and the owner of Lightwave Glass Studio in Anchorage since 1974. When she's not busy with conference preparations, Rita works afternoons with Dru at the glass shop.

\*\*\*

The **Susitna Dam Project** is alive and moving forward once again. Commencement of the

licensing process for the Susitna – Watana dam project was announced in a brief news article in December (ADN Monday, December 26, 2011: A-8). Studies of potential impacts have already begun with assessments of prior work and projections of future research that will be needed to fulfill legal requirements of environmental regulation, including Section 106 NHPA, NEPA, and other topics by

**Northern Land Use Research** of Fairbanks. See their recent data gap analyses of cultural resources and subsistence for the currently proposed project alternatives at <http://www.susitna-watanahydro.org>

\*\*\*\*

**Ben Potter** (University of Alaska Fairbanks) and **Joshua Reuther** (University of Arizona) are involved in some interesting research on the Gerstle River in central Alaska. There they have located contemporaneous early Holocene cultural sites that yielded bone, teeth, and charcoal sufficient to investigate radiocarbon variation when different materials are used and when different pretreatments are applied.

See their results in the January 2012 *American Antiquity* Vol 77 No 1: 71-98.

**Editor's Note:** Please send your news items for *Out and About to me* at [plmcclenahan@gci.net](mailto:plmcclenahan@gci.net) or [plmcclenahan@gmail.com](mailto:plmcclenahan@gmail.com)

## Recent Publications of Interest

*Richard Stern, Northern Land Use Research*

The purpose of this column is to bring recent publications in the field of Alaska anthropology to the attention of Newsletter readers. Alaska anthropology is defined broadly to include the traditional four field approach of anthropology subject matter. The Alaska region is similarly broadly defined to include Alaska, neighboring Canada, the Northwest Coast, Siberia, and more generally, the circumpolar North. Publications include published books, journal articles, web pages, unpublished reports ("grey literature"), or other information which may be of interest. Readers are urged to share publications which come to their attention with this column's compiler. The electronic format of the aaa newsletter allows for inexpensive dissemination of this information. My thanks to the many readers who have sent citations of interest to their colleagues. Please continue to

submit them! Richard Stern  
([DStern8107@aol.com](mailto:DStern8107@aol.com))

Barr, Susan and Paul Chaplin (editors)  
2011 *Polar Settlements - Location, Techniques and Conservation*. International Polar Heritage Committee (IPHC), Oslo, Norway.

Braje, Todd J. and Torben C. Rick (editors)  
2011 *Human Impacts on Seals, Sea Lions, and Sea Otters: Integrating Archaeology and Ecology in the Northeast Pacific*. University of California Press, Berkeley, California.

Broadbent, Noel D., with contributions by Jan Stora  
2011 *Lapps and Labyrinths: Saami Prehistory, Colonization, and Cultural Resilience*. Contributions to Circumpolar Anthropology Number 8. Smithsonian Institution, Arctic Studies Center, Washington, D.C.

Brown, Caroline L., James S. Magdanz and David S. Koster  
2012 *Subsistence Harvests in 8 Communities in the Central Kuskokwim River Drainage, 2009*. Technical Paper No. 365. Alaska Department of Fish and Game, Division of Subsistence, Juneau, Alaska.

Fienup-Riordan, Ann, editor and Alice Rearden, translator  
2011 *Qaluyaarmiuni Nunamtenek Qanemciput /Our Nelson Island Stories: Meanings of Place on the Bering Sea Coast*. University of Washington Press, Seattle, WA.

2012 *Ellavut/Our Yup'ik World And Weather: Continuity And Change on the Bering Sea Coast*. University of Washington Press, Seattle, WA.

Fienup-Riordan, Ann, editor  
2012 *Mission of Change: Conversations with Father Rene Astruc and Paul Dixon on Their Work With Yup'ik People, 1950-1988*. University of Alaska Press, Fairbanks, Alaska.

Fuller, Lenora Duling

- 2010 *A Rocking Chair, a Wig, Two Kids, and a Husband. Above the Arctic Circle, 1964-1965.* Northbooks, Eagle River, Alaska.

Goebel, Ted and Ian Buvit (editors)

- 2011 *From the Yenisei to the Yukon: Interpreting Lithic Assemblage Variability in Late Pleistocene/Early Holocene Beringia.* Texas A&M University Press, College Station, TX.

Holen, Daven L., Jory Stariwat, Terri Lemons and Theodore M. Kreig

- 2012 *Subsistence Harvests and Uses of Wild Resources in Aleknagik, Clark's Point, Manokotak, Alaska, 2008.* Technical Paper No. 368. Alaska Department of Fish and Game, Division of Subsistence, Anchorage, Alaska.

Koskey, Michael and Kristin Mull

- 2011 *Traditional Ecological Knowledge and Biological Sampling of Nonsalmon Fish Species in the Yukon Flats Region, Alaska.* Technical Paper No. 362. Alaska Department of Fish and Game, Division of Subsistence, Juneau, Alaska.

Mahoney, Andrew R., John R. Bockstoe, Daniel B. Botkin, Hajo Eicken and Robert A. Nisbet

- 2011 Sea-Ice Distribution in the Bering and Chukchi Seas: Information from Historical Whaleships' Logbooks and Journals. *Arctic* 64(4):465-477.

McGee, Jack B.

- 2010 Subsistence Hunting and Fishing in Alaska: Does ANILCA's Rural Subsistence Priority Really Conflict with the Alaska Constitution? *Alaska Law Review* 27(2):221-255.

Morey, Darcy F.

- 2010 *Dogs: Domestication and the Development of a Social Bond.* Cambridge University Press, Cambridge and New York.

O'Brien, Thomas A.

- 2011 *Gwich'in Athabascan Implements. History, Manufacture, and Usage According to Reverend David Salmon.* University of Alaska Press, Fairbanks, Alaska.

Schneider, William S.

- 2012 *On Time Delivery-The Dog Team Mail Carriers.* University of Alaska Press, Fairbanks, Alaska.

Spennemann, Dirk H. R.

- 2011 *The Cultural Landscape of the World War II Battlefield of Kiska, Aleutian Islands. Findings of a Cultural Heritage Survey, Carried Out in June 2009.* Institute for Land, Water, and Society, Charles Sturt University, Albury, NSW, Australia.

Spude, Catherine Holder, Robin O. Mills, Karl Gurcke and Roderick J. Sprague (editors)

- 2011 *Eldorado! The Archaeology of Gold Mining in the Far North.* University of Nebraska Press, Lincoln, NE.

Zimmerman, Larry J. and Jessica Welch

- 2011 Displaced and Barely Visible: Archaeology and the Material Culture of Homelessness. *Historical Archaeology* 45(1):67-85.

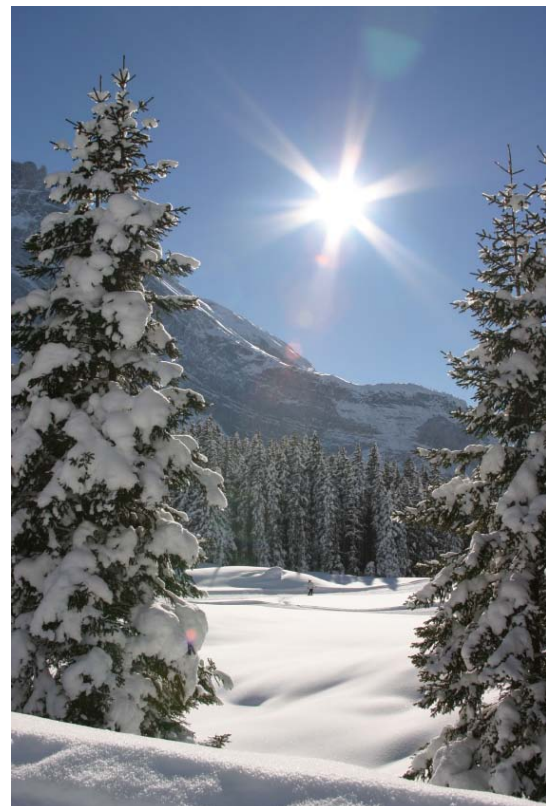



## *In Memory*



**Deanna Marie Paniataaq Kingston**  
**July 21, 1964-Dec. 2, 2011**

*Submitted by Kai Henifin*  
*Conservation Biology Institute, Corvallis, OR*

Oregon State University Professor of Anthropology, Dr. Deanna Kingston, 47, of Corvallis followed her ancestors on December 2, 2011. Deanna, descendent of the King Island Native Community, was born, raised, and resided in Oregon. She is survived by her supportive and loving family, son Edward Tattayuna Kingston, parents Olga Muktoyuk Kingston and Dalena SpiritSong Kingston, Sister Rena Seunninga, brother-in-law Henk Seunninga; niece Kenna and nephew Connor Ryan Seunninga, brothers Kevin and A. Scott Kingston and numerous family in Nome, Anchorage, Fairbanks and the greater Alaska region.

Deanna often commented that she felt she was born an anthropologist. Her love for peoples, cultures, stories and legends carried her to

many parts of the world but always brought her home. Dr. Kingston received her BS in Science Communications from the University of Portland in 1986, an MAIS in Cultural Anthropology from Oregon State University in 1993 and her PhD in Anthropology from the University of Alaska Fairbanks in 1999. In 2000, Dr. Kingston began her journey as a professor of anthropology at Oregon State University. An unfailing supporter of students of color, she worked tirelessly with Native students, advising and co-advising many native graduate students over her 10 plus years at Oregon State University. Working as an advisor for the Native American Longhouse, she supported Native students and faculty alike at OSU, and served as one of the finest role models of a colleague, friend, mentor, and scholar.

Deanna had many great accomplishments through her work, her son and family, and her open candor during her long battle with cancer. She served on the National Science Foundation's Office of Polar Programs Advisory Committee and also on the SEARCH (Study for Environmental Arctic Change) Responding to Change Panel. Dr. Kingston participated in numerous workshops and conferences including "Designing an Arctic Observing Network" in Copenhagen, Denmark, an international conference on indigenous knowledge at Pennsylvania State University and a workshop at the International Arctic Social Science Association meeting, sponsored in part by the Alaska Native Science Commission, on collaborating with Arctic communities. She was cognizant of efforts both in the circumpolar Arctic and in the Pacific Northwest to consult, respect, and collaborate with Native American/indigenous communities, particularly when it comes to their knowledge of the environment. Deanna's inspirational thoughts and ideas will be kept alive in the numerous articles and publications she wrote and in the legacy of the students she advised. Her unerring commitment to the betterment of others and her community were demonstrated in her participation in a myriad of organizations such as the International Arctic Social Science Association, Alaska Anthropology Association, the Arctic Institute of North America and the Planning Committee for the International Conference on Indigenous Placenames, Guovdageiadnu, Norway, September 2010.

In 2003 she received a National Science Foundation grant to document and compare scientific knowledge with traditional ecological



knowledge of King Island, Alaska. Thanks to her work through this grant, many King Island peoples were able to return to King Island and share their knowledge and wisdom with the younger King Islanders. This work culminated in one of her proudest accomplishments, the King Island Placenames Project interactive website that documents the cultural geography, biogeography and traditional ecological knowledge of King Island <http://www.kingislandplacename.com/>

Devoted to furthering numerous causes and helping others along their paths, Deanna kept a long-running, open, intimate diary of her journey with cancer ([deupdates.blogspot.com](http://deupdates.blogspot.com)) that was a source of inspiration and healing for her, her friends and families, and countless others living with or affected by the disease. Despite the often heavy topics of her blog posts, Deanna strove to find the humor and insight in every situation and communicate both to others. Her courageous and kind spirit will forever be missed and remembered.

About her next voyage, Deanna wrote on her blog, "don't be sad, be happy for my passing 'cause I'm going on a wonderful journey. I'm not sure where, but if you miss me, just think about me and I'll be there- wrapping you with my spirit, keeping you comfortable, wishing you well."

A public remembrance, honoring and celebration of Deanna's life is being planned at Oregon State University's Native American Longhouse. A private family ceremony will be held at a later date.

In lieu of flowers, please send donations to the Deanna Kingston Memorial at the OSU Federal Credit Union, PO Box 306 Corvallis, OR 97339-0306.

Ross E. Smith, [RSmith@swca.com](mailto:RSmith@swca.com) wrote, "I just found the following remembrance of Deanna Kingston and thought there might be people up at UAF who might appreciate this:"

<http://oregonstate.edu/dept/ncs/lifeatosu/2011/campus-community-mourns-death-of-deanna-kingston/>

"She will certainly be missed."



**Thomas Frank Eidel**  
**April 14, 1948 – Dec. 28, 2011**

Thomas "Tom: Frank Eidel, 63, passed away unexpectedly at home December 28, 2011. Tom was born in Middletown, New York on April 14, 1948. He moved to Alaska in 1966 and lived in Fairbanks and Anchorage.

Tom attended Alaska Methodist University, Anchorage Community College, and the University of Alaska. He was employed at the US Bureau of Land Management for 30 years, most recently as a digital cartographer.

Tom was a member of the American Society for Photogrammetry and Remote Sensing and the Alaska Anthropological Association. He volunteered time to the National Park Service during Alaska Archaeology Week to provide programs for children. Tom enjoyed anthropology and archaeology. He participated in several archaeological digs in Alaska.

Family and friends will all miss Tom's unique sense of humor. Tom was special in many ways and will be sadly missed. Tom is survived by his wife, Catherine Eidel; his sister, Kathleen Klein of Waverly, Tennessee; one niece, three nephews and numerous grandnieces and nephews. Tom was preceded in death by his parents, Kenneth and Marian Eidel and his brother, Ronald Eidel.

Donations can be made to the American Heart Association, American Diabetes Association, the National Kidney Foundation or the Alaska Anthropological Association.

Source: Anchorage Daily News  
Sunday, January 8, 2012 A-11

Of Tom, Association President Kerry Feldman wrote, "Tom Eidel was one of the first majors in anthropology at the University of Alaska Anchorage when I arrived in 1973. He was a very bright and hard-working student who played an important role as a student in establishing our program. He attended Alaska Anthropological Association meetings, gave solid papers, and was someone to always count on for furthering the interests of anthropology in Alaska. We will miss him very much."

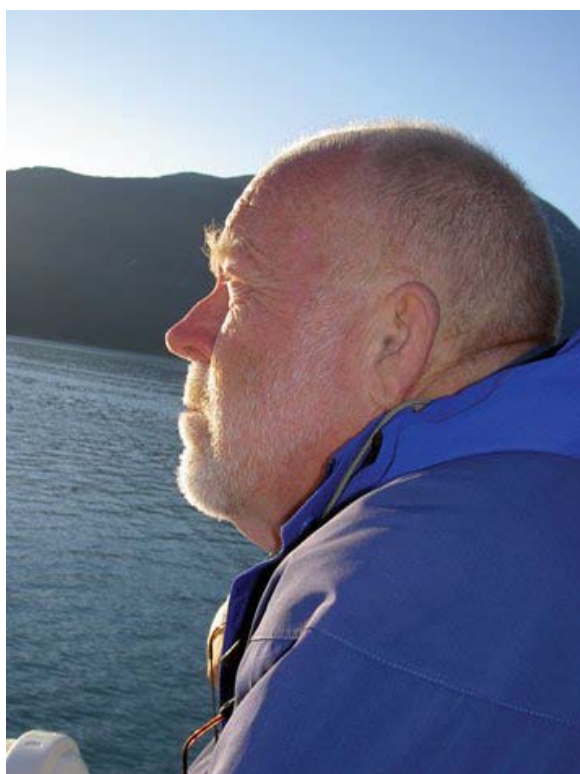

**Douglas E. Gibson**  
**Nov. 12, 1941-Dec. 24, 2011**

*Submitted by Pat McClenahan*

Doug passed away unexpectedly on Dec. 24, 2011 at his home in Eagle River. He is survived by his wife, Isolde, of Eagle River; children, Christian and Erin; grandchildren, Kegan, Eryx, Taylor and Annika Gibson, all of Sahuarita, Ariz.; and all his friends.

Doug was an archaeologist who was a longstanding member of the anthropological community in Alaska.

Doug received his B.A. from the University of California Santa Barbara, and his M.A. in Anthropology with a specialization in Archaeology from Eastern New Mexico University in 1977. His Master's Thesis was *Use-wear Analysis and Functional Interpretation of Sandia Points*. Prior to employment with the State of Alaska in the early 1980s Doug spent 1977 and 1978 teaching at the American Cooperative School in Monrovia Liberia West Africa. He was employed by the State of Alaska in the early 1980s, during which time he worked for Chuck Holmes and with Dave McMahan on highway and other projects.

Doug's interest in radiography and the use electron microscopy in archaeology persisted, and as a member of a team led by Niède Guidon, he presented study results from Pedra Furada in Brazil at the First World Summit Conference held at the University of Maine Orono in 1989.

He was subsequently employed by the Division of Cultural Resources Alaska Regional Office of the National Park Service where he accomplished archaeological surveys of Cape Krusenstern National Monument. His report was published in 1990 by National Park Service.

Most recently he was employed as an archaeologist by the Bureau of Land Management in Alaska, first at the Regional Office, and then at the Anchorage Field Office in the early 2000s. Doug enjoyed instructing in programs at the Campbell Creek Science Center and participating in Outdoor Week for local schoolchildren.

A few of Doug's numerous publications and reports include:  
1990 Cape Krusenstern National Monument: An Archaeological Survey. USDI National Park Service Alaska Region. Anchorage.

1984 Cultural Resources Survey : 1983 Investigations of Rika's Landing State Historic Site Roadhouse, Barn, and Blacksmith Shop. Alaska Department of Natural Resources Division of Geological and Geophysical Surveys. Anchorage.

1984 Cultural Resources Survey of Pedro Dome Mining/Recreation Road Upgrade. Alaska Department of Natural Resources Division of Geological and Geophysical Surveys. Anchorage.

1984 Cultural Resources Survey of the Nome-Taylor Road, Mile 13 to 21. Alaska Department of Natural Resources Division of Geological and Geophysical Surveys. Anchorage.

1984 Cultural Resources Survey: Northwestern Portion of the Ringling Site (49-GUL-077), Gulkana, Alaska. Alaska Department of Natural Resources Division of Geological and Geophysical Surveys. Anchorage.

1982 Cultural Resources Investigations of Ninilchik State Recreation Area. Alaska Department of Natural Resources Division of Geological and Geophysical Surveys. Anchorage.

1982 Cultural Resources Investigations along the Sterling Highway, Mile 82.1 to 94. Alaska Department of Natural Resources Division of Geological and Geophysical Surveys. Anchorage.

In retirement, Doug was a member of the Alaska Gas Pipeline Advisory Group, and Anchorage and Eagle River Trails Committees, planning the Campbell Creek trail and the Eagle River Beach Lake Trail.

Doug's passions were his family and his art. "He is forever in our hearts," his family said. In lieu of a memorial service, Isolde is planning to show their art at the International Gallery of Contemporary Art beginning Friday, September 7, 2012. Everyone is invited.

**Dr. Ruslan Sergeyevich Vasilevskiy  
December 26, 2011**

*Submitted by Natalia Slobodina*

Natasha Slobodina recently informed us of the passing of a Russian colleague, Dr. Ruslan Sergeyevich Vasilevskiy of the Institute of Archaeology and Ethnography (Siberian Division, Russian Academy of Science) on December 26th, 2011 in Russia. Dr. Vasilevskiy specialized in the coastal cultures of the North Pacific.

Some of his publications in English include:

Vasilevsky R.S. Fishing as an Early Form of Maritime Adaptation on the Pacific Coast of Northeast Asia Arctic Anthropology // Arctic Anthropology. – 1998. – Vol. 35. – P.281 – 295.

Vasilevsky R.S. Maritime Adaptation in Northeast Asia // J. of Korean Ancient Historical Soc. – Seoul, 1998. – N 13

He also co-authored the 2008 volume "Archaeology, Ethnography, and Anthropology of Eurasia" (in Russian).

Natasha writes, "This is a great loss to Russian archaeology. Please let me know if I can pass along the condolences to his co-workers."

Natasha can be reached at [nataslo@uw.edu](mailto:nataslo@uw.edu)

**Advertising Space is Available in the Newsletter**

*Pat McClenahan*

Space is available in the Alaska Anthropological Association Newsletter to advertise your business or product. Cost is \$50 per Newsletter publication for a one-half page advertisement. Contact Newsletter Editor Pat McClenahan at [plmcclenahan@gci.net](mailto:plmcclenahan@gci.net) if you are interested.



## 2012 Alaska Anthropological Association Membership and Journal Subscription



Please fill out *ALL* contact information fields.  
Mail to: P. O. Box 241686, Anchorage, AK 99524-1686

Name (or Institution) \_\_\_\_\_ Day Phone \_\_\_\_\_

Mailing Address \_\_\_\_\_ E-Mail \_\_\_\_\_

Affiliation \_\_\_\_\_

### Membership and Journal Subscription\*

Regular: 1 year \$75 \_\_\_\_\_ 2 years \$140 \_\_\_\_\_  
\*Student: 1 year \$40 \_\_\_\_\_ 2 years \$75 \_\_\_\_\_

Married/Partners: (2 memberships/1 journal subscription)

Name of Partner \_\_\_\_\_  
1 year \$100 \_\_\_\_\_ 2 years \$165 \_\_\_\_\_

Institutional: 1 year \$150 \_\_\_\_\_ 2 years \$300 \_\_\_\_\_

Lifetime: \$1000 \_\_\_\_\_

\*Please add \$8 per annual subscription for postage to Canada and  
\$15 outside North America.  
\*\*Photocopy of current school ID required with membership form.

### Donations

Student Scholarships \$ \_\_\_\_\_

Publication Fund \$ \_\_\_\_\_

Public Education Group \$ \_\_\_\_\_

Alaska Consortium of  
Zooarcheologists \$ \_\_\_\_\_

Stefanie L. Ludwig  
Memorial Scholarship \$ \_\_\_\_\_

### Publications

Total from second page \$ \_\_\_\_\_

**Grand Total** (Membership/Journal, Donations, Publications) \$ \_\_\_\_\_

### Payment by Check: Payable to the Alaska Anthropological Association

Credit Card payments should be made at [www.alaskaanthropology.org](http://www.alaskaanthropology.org)  
or fill out the information below VISA or Mastercard number:

Billing address zip code: \_\_\_\_\_ Total amount \$ \_\_\_\_\_

Expiration date: \_\_\_\_/\_\_\_\_/\_\_\_\_ 3-digit security code: \_\_\_\_\_

Signature: \_\_\_\_\_

*For internal use only*

Check # \_\_\_\_\_

Amount paid: \_\_\_\_\_

Deposited/charged: \_\_\_\_/\_\_\_\_/\_\_\_\_

Journal sent: \_\_\_\_/\_\_\_\_/\_\_\_\_

Publications sent: \_\_\_\_/\_\_\_\_/\_\_\_\_



Name \_\_\_\_\_

**Publications 2012**

**Aurora Monograph Series**

	Non-Member	Member	Quantity/Total Amount
When Our Bad Season Comes	\$28.00	\$22.00	/ \$
Bibliography and Index of Alaskan Archaeology	\$10.00	\$ 8.00	/ \$
The Hidden Falls Site	\$28.00	\$22.00	/ \$
In the Belly of the Whale	\$28.00	\$22.00	/ \$
Ellikarmiut: Changing Lifeways in an Alaskan Community	\$26.00	\$21.00	/ \$
People at the End of the World	\$28.00	\$22.00	/ \$

**Alaska Journal of Anthropology**

	Non-Member	Member	Quantity/Total Amount
Volume 1, Number 1	\$20.00	\$10.00	/ \$
Volume 1, Number 2	\$20.00	\$10.00	/ \$
Volume 2, Number 1-2	\$20.00	\$10.00	/ \$
Volume 3, Number 1	\$20.00	\$10.00	/ \$
Volume 3, Number 2	\$20.00	\$10.00	/ \$
Volume 4, Number 1-2	\$20.00	\$10.00	/ \$
Volume 5, Number 1	\$20.00	\$10.00	/ \$
Volume 5, Number 2	\$20.00	\$10.00	/ \$
Volume 6, Number 1-2	\$20.00	\$10.00	/ \$
Volume 7, Number 1	\$20.00	\$10.00	/ \$
Volume 7, Number 2	\$20.00	\$10.00	/ \$
Volume 8, Number 1	\$20.00	\$10.00	/ \$
Volume 8, Number 2	\$30.00	\$15.00	/ \$
TOTAL			\$

**Current issues of the Journal are included with an annual membership/subscription.**

**Postage**

USA

1 or 2 items = \$5

3 or more = \$11

Canada

1 or 2 items = \$8

3 or more = \$26

Outside North America

1 or 2 items = \$14

3 or more = \$42

Publications \$ \_\_\_\_\_

Postage \$ \_\_\_\_\_

Publication Total \$ \_\_\_\_\_

Please bring this total forward to first page.

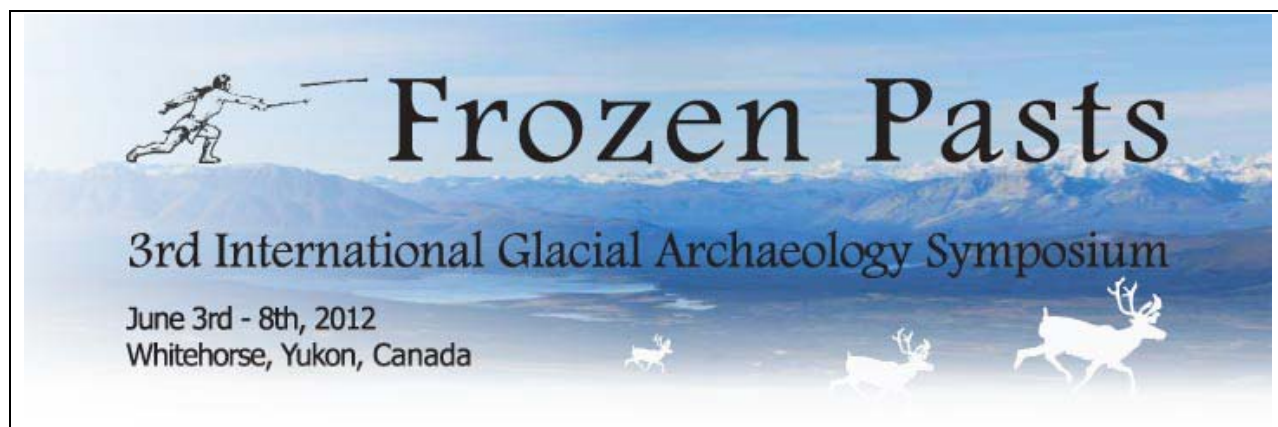

See the preliminary programme for the **3<sup>rd</sup> International Glacial Archaeology Symposium** on the conference webpage at <http://www.kwanlindunculturalcentre.com/frozenpasts/conference-program> Take a moment to visit the site and look over the list of submitted papers and presenters. For those planning to join us in Whitehorse in June 2012, please remember to register online and make your hotel reservations as soon as possible;

accommodations are scarce in Whitehorse in summer months.

Ruth Gotthardt, Ph.D.  
Yukon Archaeologist  
Heritage Resources – Cultural Services Branch  
Government of Yukon, Box 2703  
Whitehorse, YT Y1A 4M7  
Ph. 867.667.5983 Fax: 867.667.5377  
Email: [ruth.gotthardt@gov.yk.ca](mailto:ruth.gotthardt@gov.yk.ca)  
Web: [www.yukonheritage.com](http://www.yukonheritage.com)

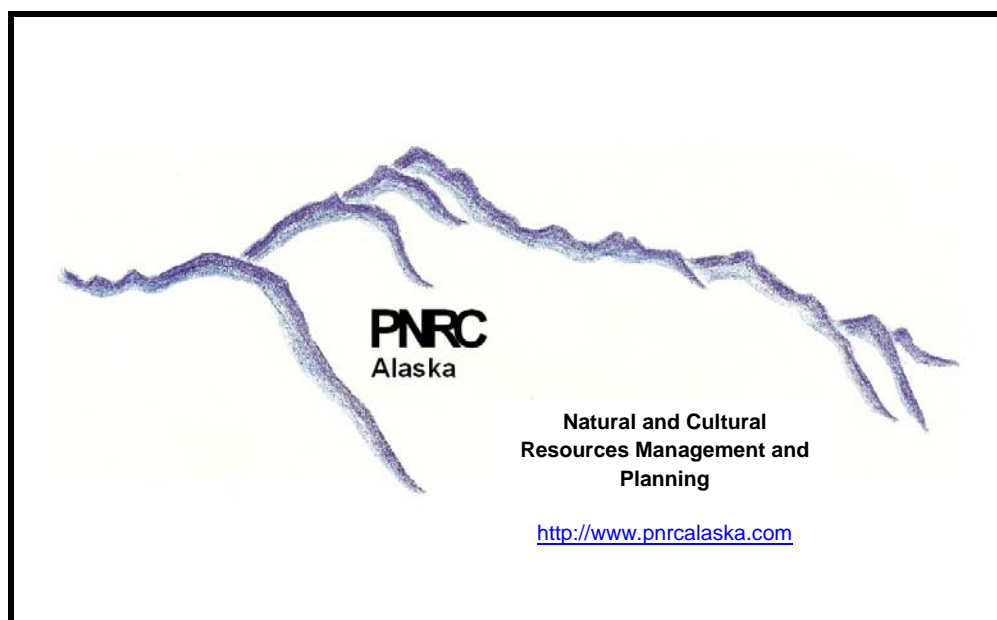

Section 2

**Alaska Anthropological Association  
39<sup>th</sup> Annual Conference  
Northern People and  
Landscapes in Times of  
Change**



**February 29 – March 3, 2012  
Hotel Deca  
4507 Brooklyn Ave NE  
Seattle, WA**

**Preliminary Program**

## Hotel Rooms

It is still possible to reserve a hotel room at Hotel Deca, though the rooms are no longer being held for us. To book a room, please contact the reservation service at 1.800.899.0251 between the hours of 8a.m. – 7p.m (PST) Monday through Friday and 10 a.m. – 4p.m. (PST) on Saturday and Sunday, fax your reservation request to 1.206.545.2103, or email request to [reservations@hoteldeca.com](mailto:reservations@hoteldeca.com) - Please mention the Alaska Anthropological Association to receive the conference discount. If you run into problems, ask to speak to the Hotel Deca staff directly. The "central reservations" service is subcontracted out and communications have not always been smooth between the hotel and reservation system regarding our conference rate.

## Getting to Hotel Deca from Sea Tac International Airport

Hotel Deca  
4507 Brooklyn Avenue NE,  
Seattle, WA 98105  
206-634-2000  
<http://www.hoteldeca.com>

There are several convenient ways to get from the airport to the University District and Hotel Deca, where the conference will be held.

**Shuttle Express** - The simplest by far is to take a Shuttle Express van ride from Level 3 of the parking garage at SeaTac to Hotel Deca. You can make reservations for one way (\$19) or round trip on the company's web site: <http://www.shuttleexpress.com/> or call (425) 981-7000. Shuttles from the airport leave on the hour, 24 hours/day.

**Taxi** – A taxi may be convenient and economical if sharing a ride between three or more people. You can expect to pay around \$50 for the one way trip.

**Public Transit:** Leave airport through skybridges (4-6) and cross through the parking garage to the Light Rail station. Purchase ticket (\$2.75) at a kiosk before boarding a train and ride light rail to Westlake Station tunnel (45 minutes). Depart light rail and pick up King County Metro buses 71, 72 or 73 at same location. Bus tickets are \$2.25 (Off-Peak); \$2.50 (Peak hours, M-F 6 to 9 AM and 3 to 6 PM). Depart bus at University Avenue and 45<sup>th</sup> Street (20 minutes) and walk west one block on 45<sup>th</sup> Street to Hotel Deca.

Hotel Deca 4507 Brooklyn Avenue NE, Seattle, WA 98105 206-634-2000  
<http://www.hoteldeca.com>



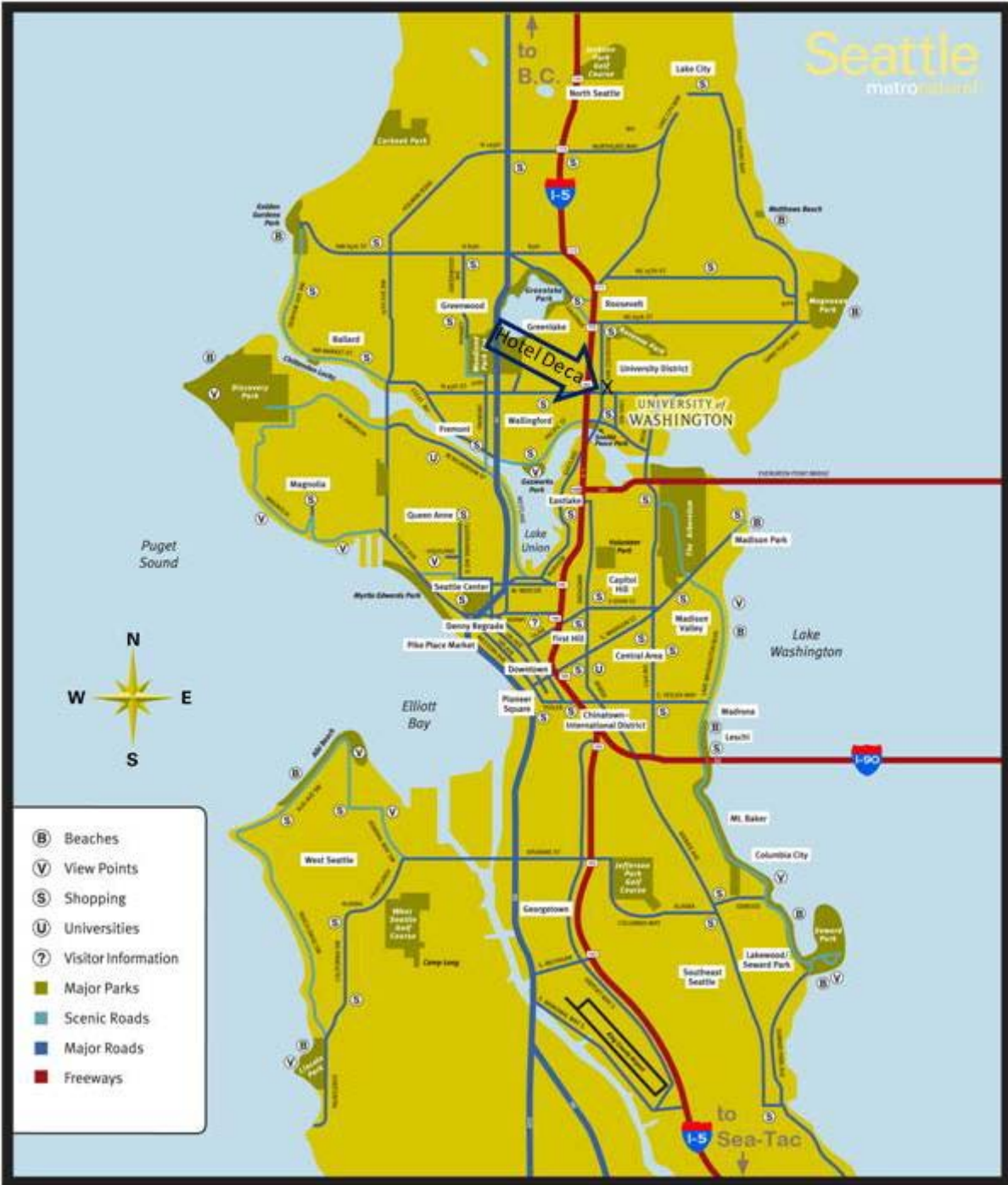

© Copyright Seattle's Convention and Visitors Bureau

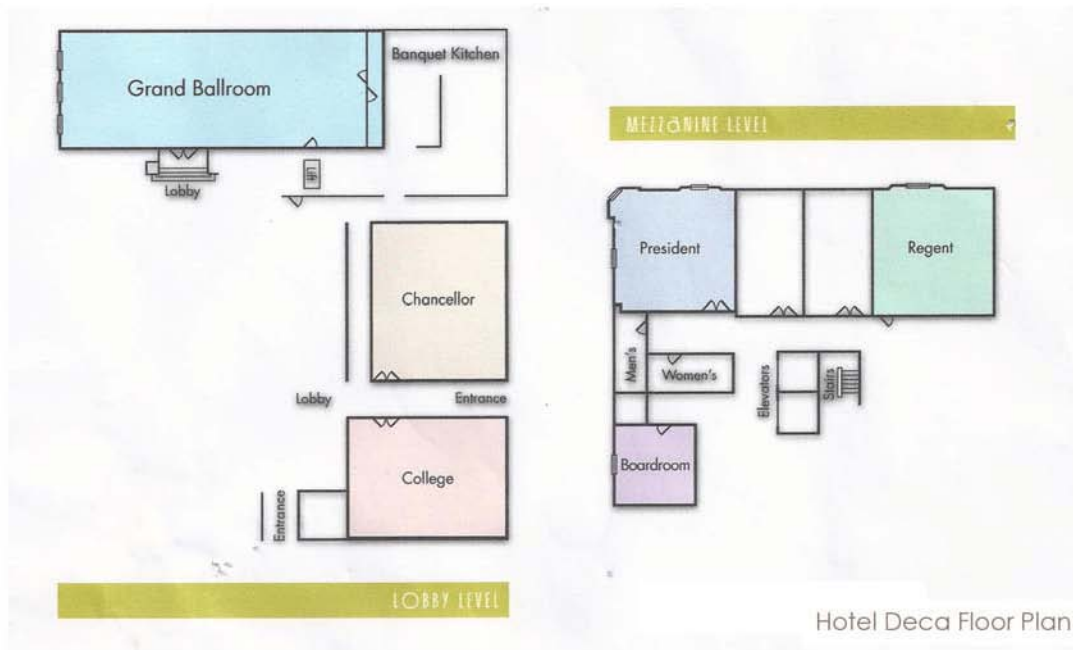

**Hotel Deca Conference Room Map**

## PRELIMINARY PROGRAM

### Host Organizations:

University of Washington Department of Anthropology  
Burke Museum of Natural History and Culture

### Organizing Committee:

Ben Fitzhugh (chair), Carol Jolles (co-chair), Mike Etnier, Shelby Anderson, Will Brown, Adam Freeburg, Erik Gjesfjeld, Molly Odell, Natasha Slobodina, Amanda Taylor, Adam Kowalski

### Confirmed Volunteers:

Kim Fleming Justin McCarthy Yoko Kugo Carey Patterson Mariana Markova  
Anastasia Tarmann

### Sponsors:

McLain Heritage Consulting Territory Heritage Resource Consulting Beta Analytic UW Bookstore Rafter Radiocarbon Dating Services

### Coffee Break Sponsors:

SWCA Environmental Consultants Northern Land Use Research, Inc  
Advocates for Archaeology and Historic NHG Alaska LLC Preservation

### Multi-Day Events

**Tours:** Participants can register for tours at the registration desk during the conference or by emailing Amanda Taylor (aktaylor@uw.edu).

**Luminescence lab** tour at the University of Washington with Dr. James Feathers. Thursday, March 1 from 12:00 - 12:30 PM, and Friday, March 2 from 10:00 - 10:30 AM. The tour group will meet at the registration desk in the Hotel Deca fifteen minutes before the tour. Limited to 10 people per tour.

**Burke Museum Archaeology Collections:** Take a behind-the-scenes tour of the Archaeology Department at the Burke Museum. The 30-40 minute tour will include the collections and research space, including highlights from Alaska and the Northwest Coast. The tour group will meet in the lobby of the Hotel Deca on Thursday, March 1 and Friday, March 2 at 12:45 PM and will walk to the Burke Museum together. Limited to 10 people per tour.

**Burke Museum Ethnology Collections:** Take a behind-the-scenes tour of the Ethnology Department at the Burke Museum. The 30-40 minute tour will include the collections storage and research space. The tour group will meet in the lobby of the Hotel Deca on Thursday, March 1 and Friday, March 2 at 12:45 PM and will walk to the Burke Museum together. Limited to 10 people per tour.

**Poster Sessions – Banquet Hall**

Poster Session 1: Thursday 8:30 AM – 5:00 PM Poster Session 2: Friday 2:30 PM – 5:00 PM and Saturday 8:30 AM – 12:30 PM

**Book Sales and Vendors – President Room**

AM – 5:00 PM Thursday and Friday

AM – 12:30 PM Saturday

**Reminder for presenters and session organizers:**

*Session Organizers:* Session chairs MUST BRING THEIR OWN LAPTOPS which will be connected to the provided AV equipment for each session/room. Presentations should be kept on schedule. Please test each PowerPoint/etc. on your laptop prior to your session time.

*Presenters:* Each presentation will be within a 20-minute time slot, including transitions. Bring a copy of your presentation on a CD or jump drive, and provide to the session organizer BEFORE your session.



**Wednesday, February 29, 2012**

**Alaska Consortium of Zooarchaeologists (ACZ):** National Marine Mammal Lab (NMML) tour and Burke Museum Mammalogy and Ornithology Collections Tour (pre-registration required through ACZ). Participants should meet at the Burke Museum Loading Dock at 9:45 AM (Northwest corner of the building).

The **AHRS Advisory Board** will meet on Wednesday February 29, 1:00 – 5:00 PM Governor's Room, Hotel Deca, Lower Level Contact: Bill Hedman, whedman@blm.gov, [William\\_Hedman@blm.gov](mailto:William_Hedman@blm.gov), 907.474.2375

Feb 28-29: (cell) 907.750.3926

- |      |  |
|------|--|
| 1:00 | Robert King, BLM State Historic Preservation Officer and Bill Hedman, BLM Central Yukon Field Office                                 |
| 1:15 | Welcome, Introductions, and the Agenda Dave McMahan, Alaska Office of History and Archaeology  |
| 1:45 | IBS User Agreement Forms: Changes, Updates, Etc. Rick Karl, AZSITE Database Manager, Arizona State University, University of Arizona |
| 2:15 | AZSite System Demonstration with emphasis on data import/export Break  |
| 2:30 | Bill Hedman and Cory Black, GIS Specialist, BLM Alaska State Office  |
| 2:45 | BLM Alaska's Archeology Data System: A WebGIS application Joan Dale, Alaska Office of History and Archaeology                        |
| 3:15 | Demo of New AHRS online applications, question and answer. Break   |
| 3:30 | Eric Ingbar, Gnomon Inc. GIS and Database Entry Tools McMahan, Ingbar, and Hedman  |
| 3:50 | Group Discussion: Prioritizing AHRS Database Development and Discussion of Future Meetings   |

**Wednesday, February 29, 2012**

**EVENING**

**Welcome Reception, Conference Registration, and No-host Bar**

6:00 – 9:00 PM Burke Museum, University of Washington (see Map for location)

**The Anthropology of Alaska, Two Minutes at a Time**

Session Chair: Jenny Blanchard (Bureau of Land Management)

6:30 – 7:30 PM Burke Room This session provides a survey of the breadth of anthropological research in Alaska over the past year, from Late Pleistocene archaeology to historical archaeology and cultural anthropology. Papers will be short and fun; this is a chance to give an abstract of research presented elsewhere in the conference, or to provide information on a single cool artifact or site or fieldwork story encountered last summer. It provides presenters with a chance to pique the audience's interest in their research, and provides audience members a chance to get an overview of the entire scope of conference topics, even if they can't attend every session they would like.

Confirmed presenters include: Jenny Blanchard Karlene Leeper Morgan Blanchard Dave McMahan Molly Casperson Craig Mishler Ben Fitzhugh Julie Raymond-Yakoubian Bill Hedman Monty Rogers Robert King

There is still room for more presenters, so if you are interested in presenting a two-minute summary of some of the work you did last year, please contact Jenny Blanchard at

[jblanchard@blm.gov](mailto:jblanchard@blm.gov) by **Wednesday, February 22<sup>nd</sup>**.

## **Thursday, March 1**

### **Registration – Hotel Deca Lobby**

8:30 AM – 5:00 PM

### **Book Sales and Vendors – President Room**

9:00 AM – 5:00 PM

### **Poster Session 1 – Banquet Hall**

8:30 AM – 4:00 PM (Poster authors will be available at their posters from 3:00 – 3:40) Norman Easton – Yukon College's Field School in Subarctic Archaeology and Ethnography for

Undergraduates Diana Ewing – Use of Baleen by Thule-period Inhabitants of Cape Espenberg, Alaska Phoebe Gilbert, Christopher Ciancibelli, and Jeffrey Rasic – Preliminary Results of the Upper

Kobuk River Archaeological Inventory and Testing Michael Grooms and Norman Easton – Stratigraphy and Chronology at the Little John Site, Yukon Territory Charles Holmes, David Fisher, and Adam Rountrey – Dental and Skeletal Evidence Point to the

Hunting of Mammoths in Central Alaska Patrick Kinkade – Shellfish Harvesting by Late Thule Occupants of Cape Espenberg, Alaska Joshua Lynch – Results of Archaeological Survey in Tetlin Region Upper Tanana Basin, Alaska Whitney McLaren and Julie Esdale – Banjo Lake Hearth Area Debitage Analysis Scott Shirar, Jeff Rasic, Eric Carlson, and Mareca Guthrie – Rock Art in the Far North: A Local

Style of Petroglyphs from the Central-Western Brooks Range

### **Thursday Morning Sessions**

#### **Late Pleistocene/Early Holocene Archaeology in Northwestern North America**

Session Chair: Ben Potter (University of Alaska Fairbanks)

#### **Chancellor Room**

9:00 Claire Alix, Gregory Hare, Thomas Andrews, and Glen MacKay – Arrow Shafts of the Northwestern Canadian Subarctic Ice Patches

9:20 P. Gregory Hare, Ruth M. Gotthardt, and Christian Thomas – Yukon's Early Holocene – A Series of Small Observations

9:40 Norman Easton, Michael Grooms, and Jordan Handley – 2011 Excavations at the Little John Site (KdVo6), Yukon Territory, Canada

10:00 Sam Coffman and Ben Potter – Lithic Analysis and Site Activities at Teklanika West (HEA-001), Central Alaska

10:20 Break

10:40 Kelly Graf, Nancy Bigelow, Ted Goebel, Angela Gore, and Angela Younie – Dry Creek Site Revisited

- 11:00 Heather Smith and Ted Goebel – Serpentine Fluted-Point Update: Report on the 2011 Excavations at BEN-192, Seward Peninsula, Alaska
- 11:20 Ian Buvit, William Hedman, Steven Kuehn, and Jeff Rasic – Geomorphology, Stratigraphy, and Formation of the Raven Bluff Site, NW Alaska
- 11:40 John P. Cook, Tom Gillispie, and Robert Sattler – Return to Healy Lake

### **The Connected Arctic**

Session Chairs: Anne Jensen (UIC Science LLC), Herbert Maschner (Idaho State University), and Owen Mason (INSTAAR, Geoarch Alaska)

#### **College Room**

- 9:20 Herbert Maschner – The Connected Bering Sea and Greater North Pacific
- 9:40 Andy Tremayne – The Denbigh Flint Complex at Cape Espenberg: Maritime Adaptation and Inland Connections
- 10:00 John Hoffecker, Owen Mason, Nancy Bigelow, Christyann Darwent, Claire Alix, Max Friesen, John Darwent, and Shelby Anderson – Cape Espenberg 2011
- 10:20 Break
- 10:40 Sarah Brown, Christyann Darwent, and Ben Sacks – Ancient DNA Analysis of Canid Remains from Cape Espenberg
- 11:00 Owen Mason and Nancy Bigelow – The Bowhead Rising: Okvik and Birnirk Affinities and the World System at Cape Espenberg
- 11:20 Shelby Anderson – Ceramic Sourcing and Social Interaction in Northwest Alaska

### **Historical Archaeology**

Session Chairs: Jim Whitney (University of Alaska Museum of the North) and Molly Proue (Northern Land Use Research, Inc.)

#### **Regent Room**

- 9:20 Richard Stern – Fort Liscum, Alaska – A U.S. Army Fort in Valdez, 1898-1922
- 9:40 Tiffany Ann Curtis and Robin Mills – DendroArchaeology on the Fortymile River, Alaska or “Get the Yeti!”
- 10:00 Paul White and William Hedman – An Archaeological Approach to Abandoned Mine Land Hazards
- 10:20 Break
- 10:40 Morgan Blanchard – The History of Portage: Trying to Understand a Wide Spot in the Road
- 11:00 Proue and Whitney – Continuing the Conversation: Forum on Collection and Curation of Historic Artifacts
- 11:20 Roundtable Discussion (30-40 min)

### **Luminescence Lab Tour at the University of Washington (~45 min)**

Meet at 11:45 at the registration desk in the Hotel Deca (limited space, sign up at registration desk)



**Burke Museum Archaeology Collections Tour and Ethnology Collections Tour (~45 min)**

Meet at 12:45 at the registration desk in the Hotel Deca (limited space, sign up at registration desk)

**Lunch 12:00 – 1:40** (on your own)

**Alaska Anthropological Association Board Meeting 12:00** Room TBA

**Thursday Afternoon Sessions****Late Pleistocene/Early Holocene Archaeology in Northwestern North America, cont'd**

Session Chair: Ben Potter (University of Alaska Fairbanks)

**Chancellor Room**

2:00 Katie Krasinski, Bryan Wygal, and Randolph Tedor – New Lacustrine Archaeological Localities at Volkmar Lake, Tanana Valley, Alaska

2:20 Gerad Smith – A tale of two cache pits: Exploring lithic behaviors associated with the late prehistoric termination of core and blade technology in Central Alaska

2:40 John Blong – Prehistoric Upland Adaptations in the Upper Susitna Basin, Central Alaska

3:00 Brian Wygal – Cold Case: Archaeological Interpretations for Post-Glacial Adaptations in Southcentral Alaska

3:20 Break

3:40 Stephan Heidenreich – What did they do in their Camps? Deciphering Site Activities and Settlement Systems in East Beringia

4:00 Joshua D. Reuther, Ben A. Potter, and James K. Feathers – Aeolian Sand Deposition during the Terminal Pleistocene and Early Holocene in the Middle Tanana Valley: Implications for Paleoenvironments and Prehistoric Land Use

4:20 Ben A. Potter – Transformations of Western Subarctic Archaeology

**The Connected Arctic, cont'd**

Session Chairs: Anne Jensen (UIC Science LLC), Herbert Maschner (Idaho State University), and Owen Mason (INSTAAR, Geoarch Alaska)

**College Room**

2:00 Amy Chan – An Ethnoarchaeological Approach to Understanding Ivory Production in Point Hope, Alaska

2:20 Anne Jensen and Glenn Sheehan – Thoughts on the Skin (and Oil) Trade

2:40 Jennifer Raff, Margarita Rzhetskaya, Justin Tackney, Dennis O'Rourke, and Geoffrey Hayes – Human Migrations in the Arctic: Mitochondrial DNA evidence for the origin of the Paleo- and Neo-Eskimo Peoples

- 3:00 Break
- 3:20 Herbert Maschner, Matthew Betts, Corey Schou, Jonathan Holmes, Robert Schlader, Nick Clement – Democratizing Science with the Virtual Zooarchaeology of the Arctic Project (VZAP)
- 3:40 Anne Jensen – Connectedness: Research Topic and Research Mode
- 4:00 Discussion

### **Collectors and Collections**

Session Chair: Jason Rogers (Northern Land Use Research, Inc.) and Evguenia Anichenko (Anchorage Museum)

#### **Regent Room**

- 1:40 Julie Hollowell – Private Collecting and the Skewed Archaeological Record for Alaskan Old Bering Sea and Okvik
- 2:00 Fawn Carter and Chris Houlette – Managing the Gadgets: Breathing New Life into Languishing Collections
- 2:20 Allison Young McLain – The Seal Stone Petroglyph: Another Alaska Mystery
- 2:40 Gudrun Bucher – Russian America to Göttingen
- 3:00 Robin Inglis – Malaspina and the Tlingit of Yakutat Bay
- 3:20 Break
- 3:40 Jason Rogers and Katerina Klápštová – From Bohemia to Yakutat: The Travels and Collections of Tadeuš Haenke
- 4:00 Jenya Anichenko - Yuri Lisianski's Collections and the first Russian round-the-world expedition
- 4:20 Gudrun Bucher – From Russian America to Oldenburg – The Kupreanof Collection in the Landesmuseum Natur und Mensch
- 4:40 Discussion

### **Thursday Evening**

**First Thursdays: Burke Museum** exhibits open 10:00 AM – 8:00 PM (free admission all day)

#### **Banquet, Keynote Address, and Awards (cash bar)**

7:00 – 8:30 PM Hotel Deca Banquet Hall

#### **Speaker: Dr. Charlotte Coté**

Dr. Coté is an Associate Professor in the Department of American Indian Studies at the University of Washington. She received her M.A. and Ph.D. at the University of California-Berkeley in Comparative Ethnic Studies and a Diploma in Broadcast Communications from the British Columbia Institute of Technology. Dr. Coté is a member of the Tseshah First Nation, one of the cultural groups which constitute the Nuuchahnulth First Nation situated on the West Coast of Vancouver Island in British Columbia, Canada. She is the author of numerous publications that focus on Indian justice systems, the Makah and Nuuchahnulth whaling tradition, and the Northwest Coast Guardian Spirit complex. Her most recent research is focused on Native American/First Nations food sovereignty issues in the United States and Canada. Dr. Coté is the author of the recently published *Spirits of Our Whaling Ancestors. Revitalizing Makah and Nuuchahnulth Traditions* (University of Washington Press, 2010).

## **Friday, March 2**

### **Registration – Hotel Deca Lobby**

8:30 AM – 12:00 PM

### **Book Sales and Vendors – President Room**

9:00 AM – 5:00 PM

### **Luminescence Lab Tour at the University of Washington (~45 min)**

Meet at 9:45 at the registration desk in Hotel Deca (limited space, sign up at registration desk)

## **Friday Morning Sessions**

### **Northern Demographies, Past and Present**

Session Chair: William Brown (University of Washington)

#### **Chancellor Room**

9:20 William Brown – Revisiting the Early Kachemak Demographic Transition

9:40 Patrick Saltonstall, Amy Steffian, and Molly Odell – Small Site Archaeology in Women's Bay: A View from the Amak Site, Kodiak Island, Alaska

10:00 Loukas Barton, Scott Shirar, Jeff Rasic, and James Jordan – Emerging Patterns in the Prehistoric Human Occupation of the Central Alaska Peninsula

10:20 Break

10:40 Patrick Plattet and Amber Lincoln – Landscape and Legacy of Alaska Peninsula Reindeer Herding: An Ethnohistory/Ethnoarchaeology Project

11:00 Nicole Hernandez, Katie Krasinski, and Brian Wygal – Discovering Chronology: Results of the 2011 Adelphi Archaeological Fieldschool in the Susitna Valley

11:20 Chris Houlette and Jim Whitney – “The Principle Constant”; Actions and adaptations of indigenous Han Athapaskan populations to gold mining efforts in the upper Yukon River region of Alaska

11:40 Elizabeth Marino – Is Shishmaref “worth saving”? An Argument for the Relocation of Communities at Risk

### **Archaeology: General Session**

Session Chair: Julie Esdale (Colorado State University, U.S. Army)

#### **College Room**

9:20 T. Weber Greiser – Working with Lew Binford in Alaska and New Mexico

9:40 G. Richard Scott, Simon Poulson, and Lindsay Dorio – Dental Calculus: A Potential Nondestructive Proxy for Stable Isotope Analysis

10:00 Kathleen Hawes – Analysis and Interpretation of Archaeological Wood Charcoal Macro-Remains

- 10:20 Break
- 10:40 Robert Bowman, Joshua Reuther, Peter Bowers, and Jason Rogers – Ground Penetrating Radar in Alaska: An Analysis of Data Recorded in 2011
- 11:00 Vladimir Pitul'ko – Yana RHS, Arctic Siberia: An Overview of the Excavations and Fieldwork in the Vicinity of the Site (2002-2011)
- 11:20 Mark Sicoli and Gary Holton – Applying Computational Phylogenetic Methods in Evaluation of the Dene-Yeniseian Hypothesis
- 11:40 Julie Esdale – Northern Archaic-Athabascan Transition in Central Alaska

### **Cultural Anthropology: General Session**

Session Chair: David Koester (University of Alaska Fairbanks)

#### **Regent Room**

- 9:00 Craig Mishler – Gwich'in Naming Ceremonies
- 9:20 David Koester – Itelmen Iterations: Documenting the Itelmen Language Hunting Stories and More
- 9:40 Alexander King – Dancing Koryaks: The Social Value of Dance Ensembles in Kamchatka
- 10:00 Katherine Arndt – Cruising the Straits: Russian-American Company Visits to Kake, Alaska, and Vicinity in the 1860's
- 10:20 Break
- 10:40 Julie Raymond-Yakoubian and Jolene Okleasik – Local and Traditional Knowledge of Non-Salmon Fish in Teller, Alaska
- 11:00 Yoko Kugo, Jennifer Burns, David Withrow, David Holen, James Van Lanen, and Helen Alderman – Unique Freshwater Seal Ecology in Iliamna Lake: Utilizing Local Ecological Knowledge and Western Science
- 11:20 Robert King – Homesteading in Alaska 1898-1988: The Final Chapter in America's Homestead Experience
- 11:40 Gregory Reinhardt – Big Chiefs and Other-Sized American Indian Stereotypes

### **Burke Museum Archaeology Collections Tour and Ethnology Collections Tour (~45 min)**

Meet at 12:45 at the registration desk in Hotel Deca (limited space, sign up at registration desk)

### **Luncheon and Keynote Address**

12:30 – 2:30 PM Hotel Deca Banquet Hall

### **Speaker: Dr. Andrzej Weber Department of Anthropology, University of Alberta-Edmonton.**

Dr. Weber is a Professor in the Department of Anthropology at the University of Alberta. He received an M.A. and a Ph.D. in Archaeology from the University of A Mickiewicz, Poland. Professor Weber's research interests include foraging adaptations of the Mesolithic and Neolithic populations of the Lake Baikal region, Siberia and Hokkaido, Japan involving subsistence activities, mobility patterns, burial ritual and social organization, and human skeletal biology. Dr. Weber has led the Baikal Archaeology Project since 2001. That work expanded in 2011 with the inception of the Baikal-Hokkaido Archaeology Project (<http://baikal.arts.ualberta.ca/>). Recent publications include the books *Prehistoric Hunter-Gatherers of the Baikal Region, Siberia: Bioarchaeological Studies of Past Lifeways*, co-edited with M.A. Katzenberg and T.G. Schurr and *KHUZHIR-NUGE XIV, a Middle Holocene Hunter-Gatherer Cemetery on Lake Baikal, Siberia: Archaeological Materials*, co-edited with O.I. Goriunova and H.G. McKenzie.

## **Friday Afternoon Sessions**

### **Poster Session 2 – Banquet Hall**

2:30 PM – 5:00 PM (poster authors will be available at their posters **Saturday** 10:20 – 11:00)

Barbara Crass, Brant Kedrowski, and Jeffery Behm – Return to FAME: Archaeochemistry of Lipids

Carol Gelvin-Reymiller, Josh Reuther, Justin Hays, Jason Rogers, and Chris Wooley – Spatial Modeling in Southwest/Southcentral Alaska  
Justin Hays, Carol Gelvin-Reymiller, Joshua Reuther, Jason Rogers, and Chris Wooley –

Iditarod National [Pre]Historic Trail Charles Holmes and Samuel Coffman – Ancestral Lake Minchumina Project (Phase 1) Joe Keeney and Robert Hickey – A Potential Method for Locating Archaeological Sites Using

High-Resolution Satellite Imagery Kelly Monteleone – Underwater Predictive Modeling for Submerged Archaeological Sites off Prince of Wales Island, SE AK Andrew Wickert, Kelly Monteleone, Jerry Mitrovica, Robert Anderson, and Craig Lee –

Beringian Paleogeography and Archaeological Site Prediction Mark Williams – Intensification of Shellfish Processing at Qwu?gwe [45TN240] Kate Yeske and Julie Esdale – Initial Investigations at Molybdenum Ridge, Tanana Basin, Central Alaska

### **Northern Demographies, Past and Present, cont'd**

Session Chair: William Brown (University of Washington)

#### **Chancellor Room**

2:40 Tobias Holzlehner – “Somehow, something broke inside the people”: Demographic Shifts and Community Anomie in Chukotka, Russia

3:00 Ben Fitzhugh and William Brown – Paleodemography of the Kuril Archipelago: Environmental Variability and Social Networks

3:20 Peter Schweitzer (discussant)

### **Enduring Cultures, Changing Landscapes in Southeast Alaska**

Session Chair: Daniel Monteith (University of Alaska Southeast)



**College Room**

- 2:40 Priscilla Schulte – Traditional Resources and Alaska Native People of Southeast Alaska  
3:00 Forest Haven – From Herring Eggs to Deer Meat: Contemporary Benefits of Traditional Resources in Southeast Alaska  
3:20 Daniel Monteith – Researching Landscape Change in Juneau  
3:40 Break

**NAGPRA at 20: "Now What?"**

Session Chairs: Angela Linn and Jim Whitney (University of Alaska Museum of the North)

**College Room**

4:00 – 5:00 NAGPRA Roundtable Discussion

**Health as a Human Landscape: A Space for Diverse Anthropologies in Health Research**

Session Chairs: Sally Carraher and Kim Fleming

**Regent Room**

- 3:40 Sally Carraher – A Journey Inside Ourselves: Mapping the Shared Spaces of Humans and Stomach Bugs  
4:00 Kim Fleming – North Carolina's Big Push: Social Action and Motivation to Re-Orient Birth in North Carolina  
4:20 Zach Hozid – Eating Habits of College Freshmen  
4:40 Michael Nowak – Community Health and the 21<sup>st</sup> Century

**Friday Evening****Friday night mixer hosted by UW graduate students (everyone welcome)**

8:00 – 10:00 PM The Rat and Raven, upstairs patio 5260 University Way NE

## **Saturday, March 3**

### **Book Sales and Vendors – President Room**

9:00 AM – 12:30 PM

### **Poster Session 2 Continued – Banquet Hall**

9:00 AM – 12:30 PM (poster authors will be available at their posters from 10:20 – 11:00) Barbara Crass, Brant Kedrowski, and Jeffery Behm – Return to FAME: Archaeochemistry of Lipids Carol Gelvin-Reymiller, Josh Reuther, Justin Hays, Jason Rogers, and Chris Wooley – Spatial Modeling in Southwest/Southcentral Alaska Justin Hays, Carol Gelvin-Reymiller, Joshua Reuther, Jason Rogers, and Chris Wooley –

Iditarod National [Pre]Historic Trail

Charles Holmes and Samuel Coffman – Ancestral Lake Minchumina Project (Phase 1)

Joe Keeney and Robert Hickey – A Potential Method for Locating Archaeological Sites Using High-Resolution Satellite Imagery

Kelly Monteleone – Underwater Predictive Modeling for Submerged Archaeological Sites off Prince of Wales Island, SE AK

Andrew Wickert, Kelly Monteleone, Jerry Mitrovica, Robert Anderson, and Craig Lee – Beringian Paleogeography and Archaeological Site Prediction

Mark Williams – Intensification of Shellfish Processing at Qwu?gwes [45TN240]

Kate Yeske and Julie Esdale – Initial Investigations at Molybdenum Ridge, Tanana Basin, Central Alaska

### **Saturday Morning Sessions**

#### **Coastal Archaeology: from the Bering Sea to the Northwest coast**

Session Chair: Michael Etnier (Western Washington University)

#### **Chancellor Room**

9:00 Kelly Eldridge – The Snake River Sandpit Site: A Late Western Thule Site in Nome, Alaska

9:20 Diane Hanson – An Amaknak Bridge Style House from an Adak Island Upland Site

9:40 Roberta Gordaoff – A Comparison of Lithic Tools from Upland and Coastal Sites on Adak Island, Alaska

10:00 Molly Casperson – The Importance of Birds in Ocean Bay Subsistence: Results from the Mink Island Site, Alaska

10:20 Break

10:40 Michael Etnier – A Unique Faunal Assemblage from the Kodiak Archipelago

11:00 Madonna Moss, Kathleen Judd, and Brian Kemp – Tlingit Salmon Use at Coffman Cove: Determining Salmon Species using Morphometric vs. Ancient DNA

- 11:20 H. Kory Cooper, Nicholas Waber, and Carey Patterson – Prehistoric Copper Innovation(s) on the Northwest Coast
- 11:40 Kathryn Bernick – Revisioning Material Culture: Northwest Coast Basketry Hats
- 12:00 Dale Croes – Salish Sea Wet Site Archaeology: Ancient Basketry as the Key to Defining Long-term Salish Heritage

### **Archaeological Compliance and Survey**

Session Chair: Peter Bowers (Northern Land Use Research, Inc. – tentative)

#### **College Room**

- 9:00 Christopher Wooley, Joshua Reuther, Justin Hays, Jason Rogers, Carol Gelvin-Reymiller, Darien Thomas, and David John – The Donlin Gold Cultural Resource Project: Surveys, Compliance and Community Archaeology
- 9:20 Jason Rogers, Joshua Reuther, Justin Hays, Carol Gelvin-Reymiller, Jill Baxter McIntosh, Robert Bowman, Patrick Hall, and Christopher Wooley – From Cook Inlet to the Middle Kuskokwim: Results from the Donlin Gold Cultural Resource Project
- 9:40 Richard Reanier – The Case of the Missing Sag River Sites
- 10:00 Martin Callanan – No Mon' No Fun? – Managing Archaeological Snow Patches on a Shoestring
- 10:20 Break
- 10:40 Alexandra Edwards – Repatriation in Practice: The Process of Repatriation in New Zealand and the United States
- 11:00 Shawna Rider – A Bridge Between Them: Controversial Archaeology in Unalaska, Alaska
- 11:20 Margan Grover – Archaeological Extinction on the Beaufort Sea Coast
- 11:40 Jay Flaming – Analytical Monitoring for Cultural Resource Vulnerability and Risk Reduction

**12:30 Lunch** (on your own)

### **Saturday Afternoon and Evening**

#### **Nano-marathon (2.62 mile run/walk)**

1:00 PM Meet on the Burke Gilman Trail between University Way NE and Brooklyn Ave Contact Natasha Slobodina for details (nataslo@uw.edu)

#### **Business Meeting, Alaska Anthropological Association**

3:00 – 4:00 PM **Chancellor Room**

**Belzoni Society Meeting** 7:00 – 10:00 PM. Dante's, upper back room. 5300 Roosevelt Way